

Cabinet and Commissioner Decision Making Meeting: 12th December 2016

Boston Park Reservoir

APPENDIX 1

Site Location

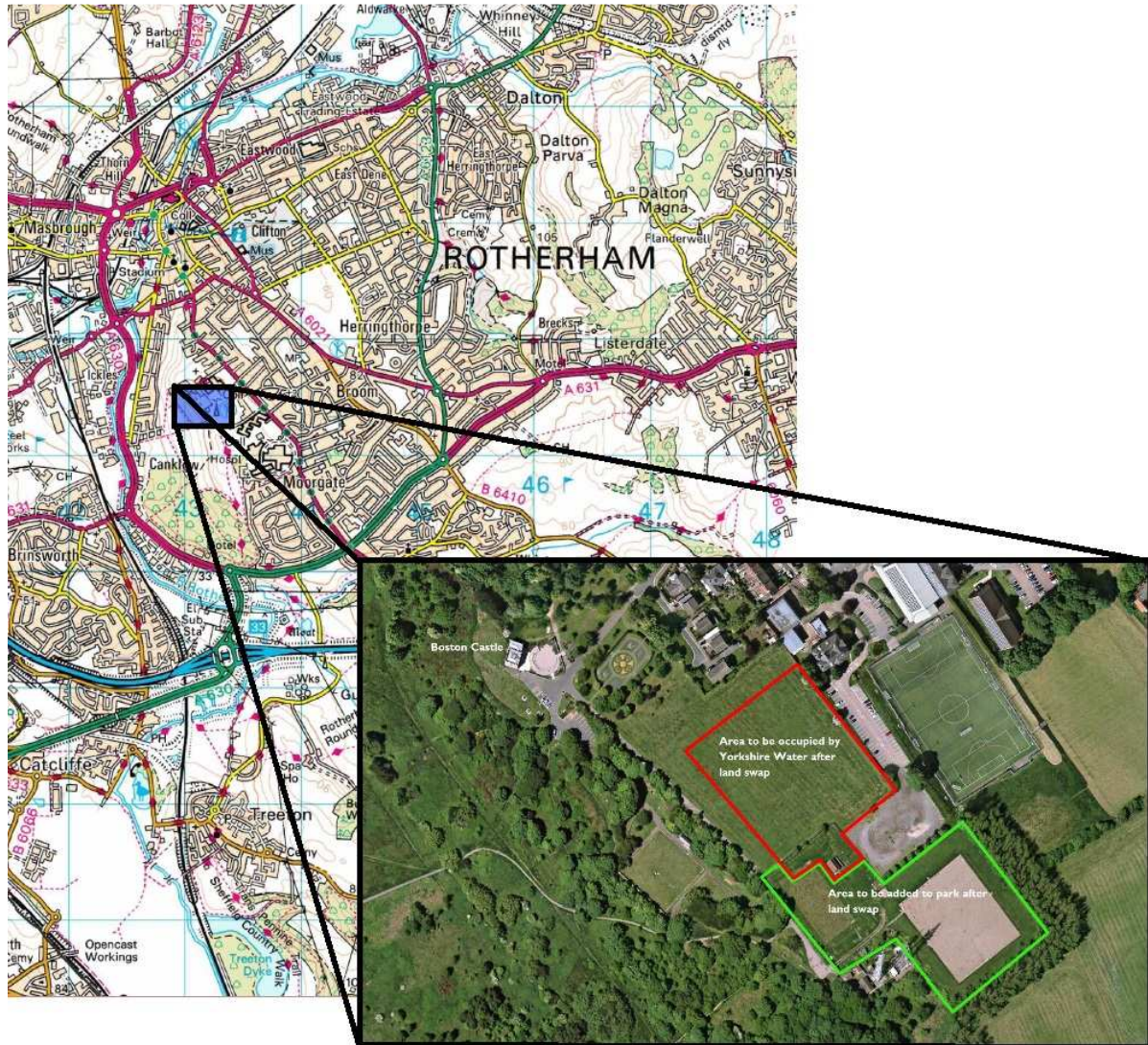

Site Layout

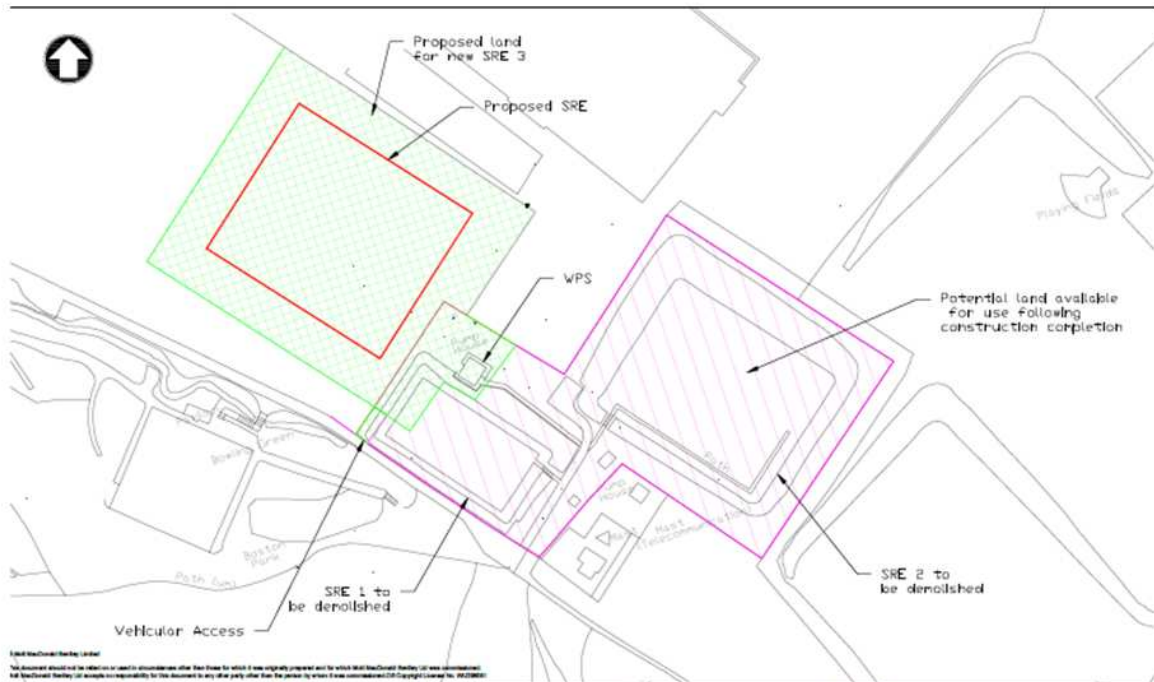

Small disclaimer text: This document should not be relied on or used in accordance with the time for which it was originally prepared and for which MMB Macdonald Bentley (or its combination) or MMB Macdonald Bentley (or its combination) is responsible to any other party other than the person to whom it was submitted. (15) Copyright (c) MMB 2002.

<p>MMB AMP3 - Asset Delivery Unit MMB Macdonald Bentley Limited 150th Street, Suite 100 Scarborough, ON M1B 3Y4 Tel: 416-291-3333 Fax: 416-291-3334 Email: info@mmbb.com</p>	<p>Yorkshire Water</p>	Client: AMP3 - Asset Delivery Unit MMB Macdonald Bentley Limited	Rev: P1 Date: 08/08/22 Drawn: GS Description: Preliminary Issue	Date: 08/08/22 Drawn: GS Description: Preliminary Issue	Date: 08/08/22 Drawn: GS Description: Preliminary Issue	Title: Boston Park SRE Investigation 12MI SRE
		Design: GS Engineering Check: GS	Date: 08/08/22 Drawn: GS Description: Preliminary Issue	Date: 08/08/22 Drawn: GS Description: Preliminary Issue	Date: 08/08/22 Drawn: GS Description: Preliminary Issue	Title: Boston Park SRE Investigation 12MI SRE
		CAD Technician: GS Lead Batch Designer Check: GS Design Manager Approval: -	Date: 08/08/22 Drawn: GS Description: Preliminary Issue	Date: 08/08/22 Drawn: GS Description: Preliminary Issue	Date: 08/08/22 Drawn: GS Description: Preliminary Issue	Title: Boston Park SRE Investigation 12MI SRE

Stream: Sabercote
 Batch No: N502
 Scheme Address: Boston Park SRE
 "Boston Park" off Sutton Castle Grove
 Rotherham, S60 2UB

YWB Ref: 0202
 OGA: -
 OGA Ref: SK-01 913
 OGA: TBC

Drawing No: N502-01-SK-022
 Scale: A3
 NTS
 Rev: P1
 Status: INF